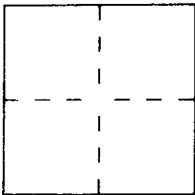

# CORNER RECORD

Document Number 5N25-16-05City of UNINCORPORATEDCounty of MONO

, California

Brief Legal Description

LOT 15 BRIDGEPORT LAKE RESORT SUBDIVISION FILED IN BOOK 1 OF MAPS, PAGE 54 AND LOCATED IN A PORTION OF SEC 16, T5N, R25E, MDM

CORNER TYPE SW'LY CORNER LOT 15

COORDINATES  
(Optional)

Government Corner ☐ Control ☐  
Meander ☐ Property ☒  
Rancho ☐ Other ☐  
Date of Survey MARCH 31, 2022

N. \_\_\_\_\_  
E. \_\_\_\_\_  
Zone \_\_\_\_\_ Datum \_\_\_\_\_  
Elev. \_\_\_\_\_

Corner — Left as found ☐ Found and tagged ☐ Established ☐ Reestablished ☒ Rebuilt ☐

Identification and type of corner found: Evidence used to identify or procedure used to establish or reestablish the corner:  
2x2 HUB PER MB 1/54 NOT FOUND. PT 25A NOT FND. -FALLS IN DEVELOPED & LANDSCAPED YARD. CORNER  
RESET BY RECORD BEARING OF S33° 15' 30"E AND DISTANCE OF 61.63' FROM PT 24A. BASIS OF  
BEARING: MEASURED BEARING OF S08° 21' 30"E BETWEEN PT 23A A 1" INNER Ø IRON PIPE & TAG INS.  
23A AND PT 24A, A 1" INNER Ø IRON PIPE AND TAG INS. 24A.

A description of the physical condition of the monument as found and as set or reset: \_\_\_\_\_  
MONUMENT 23A WAS FOUND IN GOOD CONDITION 0.2' ABOVE GROUND ADJACENT TO AND E'LY FROM A  
2'Ø RK. MND. MONUMENT 24A WAS FOUND IN GOOD CONDITION 0.1' ABOVE GROUND IN A 3'Ø RK. MND.  
SET A 2"Ø ALUMINUM CAP INS. LS5149 ON A 5/8"Ø X 24' LONG REBAR UP 0.2' @ SW'LY  
CORNER LOT 15.

## SURVEYOR'S STATEMENT

This Corner Record was prepared by me or under my direction in conformance with  
the Land Surveyors' Act on APRIL 13, 2022 19\_\_\_\_.

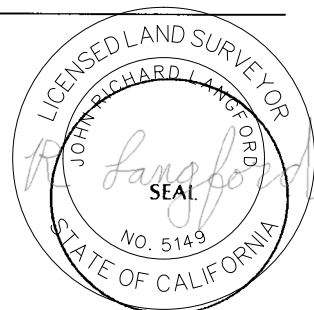
Signed John R Langford L.S. or R.C.E. Number LS5149EXP DATE 6/30/23  
4/13/2022

## COUNTY SURVEYOR'S STATEMENT

This Corner Record was received June 25, 2022 19\_\_\_\_ and examined  
and filed \_\_\_\_\_ 19\_\_\_\_.

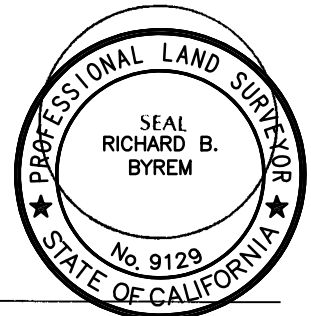
Signed [Signature] Title County Surveyor

County Surveyor's Comment \_\_\_\_\_

