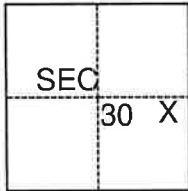

CORNER RECORD

Agency Index

5S31-30-11

Document Number

City of _____ County of MONO, CaliforniaBrief Legal Description PARCEL 3 SIERRA PARADISE UNIT 1 MB 6 PG 44**CORNER TYPE****COORDINATES (Optional)**

T5S R31E MDB&M

- | | |
|--|--|
| <input type="checkbox"/> Government Corner | <input type="checkbox"/> Control |
| <input type="checkbox"/> Meander | <input checked="" type="checkbox"/> Property |
| <input type="checkbox"/> Rancho | <input type="checkbox"/> Other |

Date of Survey 09/30/2024

N. _____ E. _____
Elevation _____
Units ☐ Metric ☐ U.S. Survey Foot
Horizontal Datum _____
Zone _____ Epoch Date _____
Vertical Datum _____
☐ Complies with Public Resources Code §§8801-8819
☐ Complies with Public Resources Code §§8890-8902

PLS Act Ref.:

☒ 8765(d)☐ 8771☐ 8773☐ Other:Corner/
Monument:☐ Left as found☐ Established☐ Rebuilt☐ Pre -Construction☒ Found and tagged☒ Reestablished☐ Referenced☐ Post-Construction

Narrative of corner identified and monument as found, set, reset, replaced, or removed:

☒ See sheet #2 for description(s):

SET NE, SW, SE CORNERS PARCEL 3. TAGGED NW CORNER PARCEL 3.

SURVEYOR'S STATEMENT

This Corner Record was prepared by me or under my direction in conformance with

the Professional Land Surveyors' Act on 09/30/2024

Signed

P.L.S. or R.C.E. No.

PLS 7002**COUNTY SURVEYOR'S STATEMENT**This Corner Record was received November 13, 2024and examined and filed November 13, 2024

Signed

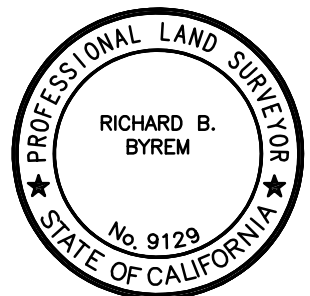
P.L.S. or R.C.E. No. 9129Title Mono County Surveyor**County Surveyor's Comment**

This document has been examined in conformance with Section 8766, Professional Land Surveyor's Act. It has been examined for technical detail, presentation, and compliance with said Act. Said examination is not a certification, or validation, of any professional decisions made by the submitting surveyor as to the location or replacement of any real property corners.

