

60 LS 89

TOWNSHIP 33 NORTH, RANGE 2 EAST

SURVEYOR'S STATEMENT

THIS MAP CORRECTLY REPRESENTS A SURVEY MADE BY ME OR UNDER MY DIRECTION IN CONFORMANCE WITH THE REQUIREMENTS OF THE PROFESSIONAL LAND SURVEYORS' ACT AT THE REQUEST OF SIERRA PACIFIC INDUSTRIES IN SEPT. 2020

(SIGNED AND SEALED)

GREGG NEITSCH, L.S. 7991

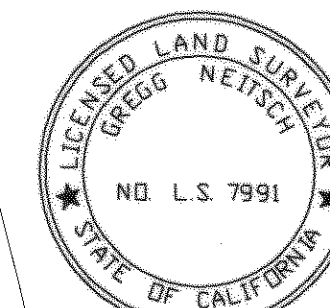

DATE: OCT. 24, 2022

COUNTY SURVEYOR'S STATEMENT

THIS MAP HAS BEEN EXAMINED IN ACCORDANCE WITH SECTION 8766 OF THE PROFESSIONAL LAND SURVEYORS' ACT THIS 10th DAY OF NOVEMBER, 2022.

(SIGNED)

SHASTA COUNTY SURVEYOR LS NO. 8979
ALFRED V. CATHEYDEPUTY LS NO. 8055
COUNTY SURVEYOR

RECORDER'S STATEMENT

FILED THIS 15th DAY OF November, 2022, AT 10:01 A.M. IN BOOK 60 OF LAND SURVEYS AT PAGE 89 AT THE REQUEST OF G. NEITSCH

(SIGNED)

LESLIE MORGAN
SHASTA COUNTY RECORDER

FEE 11.00 PAID

RECORD OF SURVEY

FOR

SIERRA PACIFIC LAND & TIMBER COMPANY

LOCATED IN THE WEST 1/2 OF SEC. 5,
AND THE E1/2 AND SW1/4 OF SEC. 6,
T.32N., R.2E., M.D.B. & M.,
UNINCORPORATED TERRITORY OF
SHASTA COUNTY, CALIFORNIA

NORTH STATE LAND SURVEYING
MOUNT SHASTA, CAAUGUST 2022 SCALE: 1"=800' SHEET 1 OF 2
GLENND.ASC GLENDENNING.GXD JOB NO. 665 DB: DN0 800 1600
SCALE: 1"= 800'

S36, T.32N. R.1E.

SIERRA PACIFIC LAND
& TIMBER COMPANY
D.N. 2018-0018239

REFERENCES

- R1 = 23 LS 6 (SARGENT)
R2 = 1881 GLO SURVEY BY SANDOW
R3 = 16 LS 11 (SARGENT)
R4 = 16 LS 4 (SARGENT)
R5 = 16 LS 2 (SARGENT)

S1, T.32.N., R.1E.

SHASTA FORESTS
TIMBERLANDS LLC
D.N. 2011-0029534S12,
T.32N., R.1E.FALLBROOK VERDE ESTATES LLC
D.N. 2005-0061180REED FAMILY
TRUST ETAL
D.N. 2018-0006391

LEGEND OF SYMBOLS & ABBREVIATIONS:

⊙ SET SURVEY MONUMENT AS DESCRIBED.

⊕ FOUND SURVEY MONUMENT AS DESCRIBED.

IP	IRON PIPE	AC	ALUMINUM CAP
()	RECORD DISTANCE	IC	INCENSE CEDAR
F	FIELD MEASUREMENT	YP	YELLOW PINE
D.N.	DOCUMENT NUMBER	BO	BLACK OAK
MOS	MOUND OF STONE	HB	HEALED BLAZE
VS	VISIBLE SCRIBING	WF	WHITE FIR
AP	ALUMINUM POST	DF	DOUGLAS FIR
		IDF	IDENTIFICATION

NOTES

- IT IS NOT THE PURPOSE OF THIS SURVEY TO LOCATE EASEMENTS, RECORDED OR NON-RECORDED ENCROACHMENTS, LINES, CORNERS, CONFLICTS, FENCES, AND/OR ANY OTHER SURVEY DATA EXCEPT THAT SHOWN HEREON.
- THE PURPOSE OF THIS SURVEY IS TO MEASURE AND MARK THE SOLID LINES SHOWN IN BOLD HEREON.
- THIS FIELD SURVEY BEGAN SEPTEMBER 30, 2020 AND WAS COMPLETED JULY 19, 2022.
- BEARINGS ARE ASTRONOMIC BASED ON A SOLAR OBSERVATION AT THE E 1/16 CORNER OF SECTION 6 AT 80 CHAINS.

CORNER DESCRIPTIONS

A. C-1/4 CORNER OF SECTION 6, T.32N., R.2E.:
FOUND 3/4" IP WITH BRASS TAG STAMPED
"LS 2322", PER R1, FROM WHICH BEARS:

19" WF SNAG ROTTED BLAZE N17°E 4.6' F=R1
14" WF SNAG WITH HB N76°E 9.2' F (NO RECORD)
9" IC WITH HB S67 1/4°W 16.0' F (NO RECORD)
7" IC SCRIBED XBT THIS SURVEY S 34 1/2°E 20.3' F

B. C-W 1/16 CORNER OF SECTION 6, T.32N., R.2E.:
FOUND 3/4" IP WITH BRASS TAG STAMPED
"LS 2322", PER R1, FROM WHICH BEARS:

21" YP WITH HB N30°E 11.6' F (NO RECORD)
15" YP WITH HB S78 1/4°E 6.0' F (NO RECORD)
ROTTED FIR STUMP N45°E 14.5' (F=R1)

C. SW 1/16 CORNER OF SECTION 6, T.32N., R.2E.:
FOUND 3/4" IP WITH BRASS TAG STAMPED
"LS 2322", PER R1, FROM WHICH BEARS:

16" YP WITH HB S58 1/2°W 6.9' F (NO RECORD)
21" IC STUMP WITH HB S80°W 7.8' F=R1
17" YP WITH HB S39°E 24.5' F (NO RECORD)

D. S 1/16 CORNER OF SECTION 6 ON RANGE LINE,
T.32N., R.2E.: FOUND 3/4" IP WITH BRASS
TAG STAMPED "LS 2322", PER R1, FROM WHICH BEARS:

4" YP SCRIBED XBT THIS SURVEY S65 1/2°E 11.0' F
14" YP WITH HB S4°E 16.4' F (NO RECORD)

E. CORNER OF SECTIONS 1 AND 12 ONLY, T.32N., R.1E.:
FOUND 3/4" IP WITH NO IDF, PER R4,
FROM WHICH BEARS:

11" YP WITH HB N16 1/2°W 12.5' F (NO RECORD)
20" YP WITH HB S65 1/4°E 7.6' F (NO RECORD)
15" YP WITH HB S23°W 32.9' F (NO RECORD)

F. 1/4 CORNER OF SECTIONS 6 AND 7,
T.32N. R.2E.: FOUND 2 1/2 " AP
WITH 3 1/4" AC STAMPED "LS 4655",
UNKNOWN RECORD, FROM WHICH BEARS,

27" DF SCRIBED XBT THIS SURVEY
S36 1/4°W 83.9' F
37" IC WITH K-TAG
N87 1/4°E 46.3' F
(R3 = N83°E 47.6')

G. CORNER OF SECTIONS 6
AND 7 ONLY, T.32N., R.2E.:
FOUND 1 1/4" GIP WITH BRASS TAG
STAMPED "LS 2322", PER R3,
FROM WHICH BEARS:

21" YP WITH HB S24°W 22.2' F
(R3 = S42W 22.5')
19" YP WITH HB
N28 1/4°E 29.3' F
18" IC STUMP
N33°E 4.8' F=R3

H. E 1/16 CORNER AT 80 CHAINS
OF SECTION 6, T.32N., R.2E.:
FOUND 3/4" IP WITH BRASS
TAG STAMPED "LS 2322",
PER R1, FROM WHICH BEARS:

5" IC SCRIBED XBT THIS SURVEY
N83°W 8.5' F
6" BO SCRIBED XBT THIS SURVEY
S4 3/4°E 7.4' F
8" BO SNAG WITH VS
S23°E 8.3' F=R1

I. N 1/16 CORNER OF SECTIONS 6 AND 5
AT 80 CHAINS, T.32N., R.2E.:
FOUND 3/4" IP WITH BRASS TAG
STAMPED "LS 2322", PER R1,
FROM WHICH BEARS:

15" YP WITH HB
N13°E 7.5' (NO RECORD)
32" DF STUMP
N82 1/2°E 17.5' F
(R1 = N82°E 18.7')
12" YP WITH HB
S81 3/4°W 3.7' F (NO RECORD)

J. N 1/16 CORNER OF SECTIONS
6 AND 5 AT 100 CHAINS, T.32N., R.2E.:
FOUND 3' MOS WITH PIPE MISSING.
SET 1/2" REBAR IN CENTER OF MOS
WITH 1 1/2" AC STAMPED LS 7991",
FROM WHICH BEARS:

7" IC SCRIBED XBT THIS SURVEY
N75°E 14.3' F
6" IC SCRIBED XBT THIS SURVEY
S25 3/4°W 13.3' F

K. E 1/16 CORNER OF SECTIONS
6 AND 7, T.32N., R.2E.:
FOUND MONUMENT HOLE IN
CENTER OF 3' MOS WITH
T-POST AND K TAG. NO EVIDENCE
OF IRON PIPE. SET 5/8" REBAR
WITH 1 1/2" AC STAMPED
"LS 7991" IN 3' MOS, FROM
WHICH BEARS:

10" IC SCRIBED XBT THIS SURVEY N8°W 9.9' F
13" YP SCRIBED XBT THIS SURVEY S66 3/4°E 7.0' F

L. C-E 1/16 CORNER OF SECTION 6, T.32N., R.2E.:
FOUND 3/4" IP WITH ILLEGIBLE BRASS TAG,
PER R1, FROM WHICH BEARS:

6" IC SCRIBED XBT THIS SURVEY N4°E 12.5' F
7" WF SCRIBED XBT THIS SURVEY S27 1/2°W 26.6' F

M. SOUTH 1/4 CORNER OF SECTION 32 ONLY,
T.33N., R.2E.: FOUND 3/4" IP WITH BRASS TAG
STAMPED "LS 2322", PER R1, FROM WHICH BEARS:

49" YP SNAG WITH VS S44°W 17.6' F (R1 = S44 1/2°W 16.5')
48" IC WITH HB N85°E 55.5' F=R1

N. E 1/4 CORNER OF
SECTION 1 ONLY, T.32N. R.1E.:
FOUND 3/4" IP WITH BRASS TAG
STAMPED "LS 2322", PER R5,
FROM WHICH BEARS:

13" YP SCRIBED XBT THIS SURVEY
N57 1/2°E 10.7' F
24" IC WITH HB
N68 1/4°W 19.1' F (NO RECORD)

O. W 1/16 CORNER OF SECTION 5
AT 100 CHAINS, T.32N., R.2E.:
FOUND 3/4" IP WITH BRASS TAG
STAMPED "LS 2322",
PER R1, FROM WHICH BEARS:

19" YP WITH HB S4 3/4°W
22.8' F (NO RECORD)

P. C-W 1/16 CORNER OF SECTION 5,
T.32N., R.2E.: FOUND 3/4" IP
WITH BRASS TAG STAMPED "LS 2322",
PER R1. TOP 12" OF PIPE BENT OVER
DUE TO LOGGING EQUIPMENT. RESET IP
WITH 1/2" REBAR AND 1 1/2" AC STAMPED
"LS 7991", FROM WHICH BEARS:

19" YP SCRIBED XBT THIS SURVEY
S37 3/4°E 9.5'
13" IC SCRIBED XBT THIS SURVEY
N25 1/2°E 16.5'

Q. SW 1/16 CORNER OF
SECTION 5, T.32N., R.2E.:
FOUND 3/4" IP WITH BRASS
TAG STAMPED "LS 2322", PER R1,
FROM WHICH BEARS:

15" YP SCRIBED XBT THIS SURVEY
N9°W 6.9' F
19" IC SCRIBED XBT THS SURVEY
S49 1/2°E 19.3' F

R. S 1/16 CORNER OF SECTIONS
6 AND 5, T.32N., R.2E.:
FOUND 3/4" IP WITH BRASS
TAG STAMPED "LS 2322",
PER R1, FROM WHICH BEARS:

12" YP SCRIBED XBT THIS SURVEY
S47 1/2°E 9.2' F
15" YP SCRIBED XBT THIS SURVEY
N35 1/4°E 4.0' F

S. CORNER OF SECTIONS 6, 5,
7 AND 8, T.32N., R.2E.:
FOUND 3/4" IP WITH BRASS
TAG MARKED "LS 2322",
PER R3, FROM WHICH BEARS:

12" YP WITH HB
S42 1/4°W 14.3' F (NO RECORD)
ROTTED PINE STUMP
N51°E 50.7' F=R3
32" IC WITH BARK SCRIBED
S73°E 58.6' F (NO RECORD)
45" IC S54 1/4°W 47.4' F
(R2 = S49°W 46.2')

REFERENCES

R1 = 23 LS 6 (SARGENT)
R2 = 1881 GLO SURVEY BY SANDOW
R3 = 16 LS 11 (SARGENT)
R4 = 16 LS 4 (SARGENT)
R5 = 16 LS 2 (SARGENT)

LEGEND OF SYMBOLS & ABBREVIATIONS:

⊙ SET SURVEY MONUMENT AS DESCRIBED.

● FOUND SURVEY MONUMENT AS DESCRIBED.

IP	IRON PIPE	AC	ALUMINUM CAP
()	RECORD DISTANCE	IC	INCENSE CEDAR
F	FIELD MEASUREMENT	YP	YELLOW PINE
D.N.	DOCUMENT NUMBER	BO	BLACK OAK
MOS	MOUND OF STONE	HB	HEALED BLAZE
VS	VISIBLE SCRIBING	WF	WHITE FIR
AP	ALUMINUM POST	DF	DOUGLAS FIR
		IDF	IDENTIFICATION

RECORD OF SURVEY

FOR

SIERRA PACIFIC LAND &
TIMBER COMPANY

LOCATED IN THE WEST 1/2 OF SEC. 5,
AND THE E1/2 AND SW1/4 OF SEC.6,
T.32N., R.2E., M.D.B. & M.,

UNINCORPORATED TERRITORY OF
SHASTA COUNTY, CALIFORNIA

NORTH STATE LAND SURVEYING
MOUNT SHASTA, CA

AUGUST 2022 SHEET 2 OF 2
GLENND.ASC GLENDENNING.GXD JOB NO. 665 DB: DN