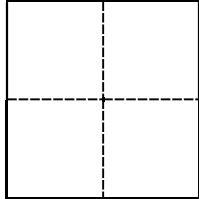

# CORNER RECORD

Agency Index 129-47-55Document Number 6339City of San Jose County of Santa Clara, CaliforniaBrief Legal Description Monument located within Spinnaker Drive 585'± northeasterly of the intersection of Spinnaker Drive and Judith Street per 255 M 15**CORNER TYPE****COORDINATES (Optional)**

Government Corner ☐ Control ☐  
Meander ☐ Property ☐  
Rancho ☐ Other ☒  
Aug. 19, 2019 Found  
Nov. 15, 2019 X-Ties  
Date of Survey Dec. 14, 2019 Punched

N. \_\_\_\_\_ E. \_\_\_\_\_

Elevation \_\_\_\_\_

Units Metric ☐ U.S. Survey Foot ☐

Horizontal Datum \_\_\_\_\_

Zone \_\_\_\_\_ Epoch Date \_\_\_\_\_

Vertical Datum \_\_\_\_\_

☐ Complies with Public Resources Code §§8801-8819☐ Complies with Public Resources Code §§8890-8902PLS Act Ref.: ☐ 8765(d) ☒ 8771 ☐ 8773 ☐ Other:Corner/Monument: ☐ Left as found ☐ Established ☐ Rebuilt ☐ Pre-Construction☐ Found and tagged ☒ Reestablished ☒ Referenced ☒ Post-Construction

Narrative of corner identified and monument as found, set, reset, replaced, or removed:

☒ See sheet #2 for description(s):

Found and set monuments as shown on Page 2.

This Corner Record is being filed solely for the perpetuation of found monument locations, and claims no responsibility for the position of the corners relative to record position or location.

**SURVEYOR'S STATEMENT**

This Corner Record was prepared by me or under my direction in conformance with

the Professional Land Surveyors' Act on 4/16/2025.Signed Steve G. Choy P.L.S. or R.C.E. No. LS 6672**COUNTY SURVEYOR'S STATEMENT**This Corner Record was received April 16, 2025and examined and filed April 16, 2025.Signed August Hanks P.L.S. or R.C.E. No. 9274Title County Surveyor**County Surveyor's Comment**

SRV23-0539



## LEGEND

⊙ FOUND PUNCHED 5/8" BRASS PIN IN CONCRETE. THE MON. WAS REFERENCED BY SETTING BRASS TACK AND TAGS STAMPED "CSJ SURVEY". THE MON. WAS REPLACED BY A 2-1/2" PUNCHED BRASS DISC IN CONCRETE, STAMPED "CSJ MONUMENT", IN MON. BOX AS NOTED IN CSJ SURVEY FIELD BOOK 1403, PAGE 38.

● FOUND PUNCHED 5/8" BRASS PIN IN CONCRETE.

⬢ SET BRASS TACK AND TAG STAMPED "CSJ SURVEY" ON TOP OF CURB UNLESS NOTED OTHERWISE.

CSJ = CITY OF SAN JOSE  
 MON. = MONUMENT  
 F/C = FACE OF CURB  
 R/W = RIGHT OF WAY  
 F/W = FACE OF WALK

## REFERENCES

(R1) BOOK 255 OF MAPS, PAGE 15

## NOTES:

1. OPPOSITE ANGLES BETWEEN TIES ARE CONGRUENT UNLESS NOTED OTHERWISE.
2. BEARINGS SHOWN ARE FOR REFERENCE ONLY AND WERE NOT VERIFIED IN THE FIELD.

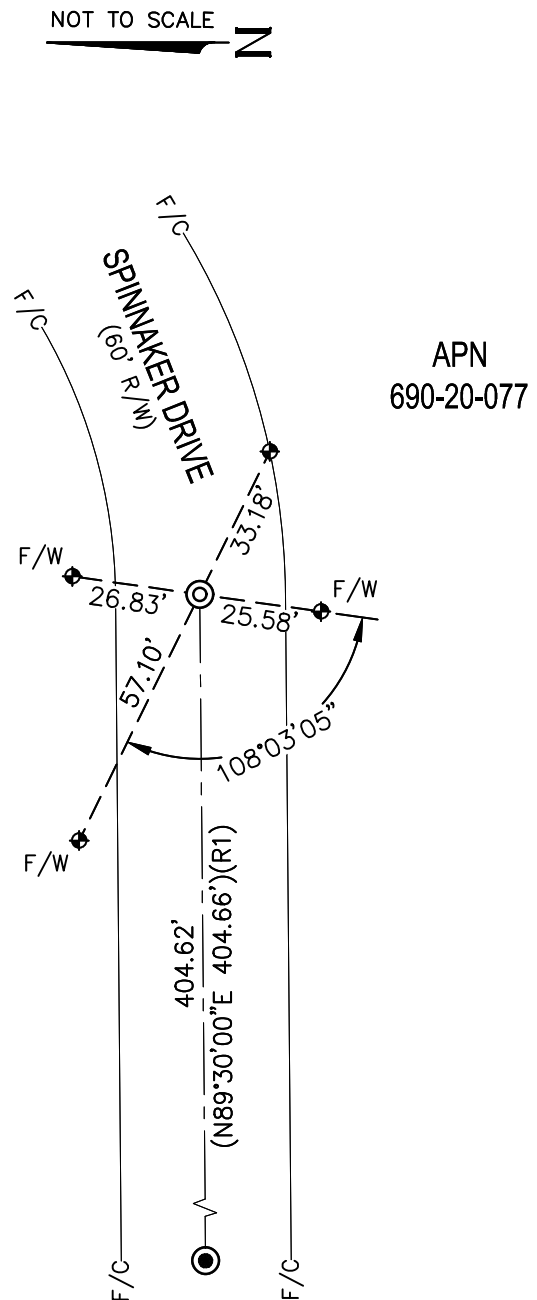

DRAWN BY: S. WONOSAPUTRA  
 CHECKED BY: C. WILSON