

-----	BOUNDARY OF SUBJECT PROPERTY
-----	OTHER LINES OF POSSESSION
-----	OLD PROPERTY LINE
-----	RIGHT-OF-WAY EASEMENT LINE
-----	CENTER LINES
●	FOUND CITY MONUMENT AS NOTED
●	FOUND 3/4" IRON PIPE, AS NOTED
▲	FOUND RR SPIKE PER R1
×	FOUND NAIL AS NOTED HEREON
■	FOUND HUB & TACK, U.O.

AC.	ACRES
DOC.	DOCUMENT
C	CALCULATED DISTANCE
FND	FOUND
I.P.	IRON PIPE
LP	LIMITED PARTNERSHIP
LLC	LIMITED LIABILITY COMPANY
M	MAP
MH	MANHOLE
MON	MONUMENT
N	NUMBER
O.R.	OFFICIAL RECORD
O.U.	ORIGIN UNKNOWN
PC	PROPERTY CORNER
R1	REFERENCE NUMBER (TYPICAL)
R/W	RIGHT OF WAY
S.F.	SQUARE FEET
SFNF	SEARCHED FOR NOT FOUND
U.O.	UNKNOWN ORIGIN

THE BEARING OF NORTH 16°03'00" EAST TAKEN ON THE
CENTERLINE OF ACACIA AVENUE AS SHOWN ON THAT CERTAIN
PARCEL MAP FILED FOR RECORD ON MAY 30, 2006 IN BOOK 801
OF MAPS AT PAGES 48 & 49, SANTA CLARA COUNTY RECORDS
WAS TAKEN AS THE BASIS OF ALL BEARINGS SHOWN HEREON.

- ① RESUBDIVISION OF SUNNYSIDE ADDITION (L M 70)
- ② GRANT DEED (DOC. 23052739)
- ③ PARCEL MAP (832 M 44)
- ④ PARCEL MAP (407 M 47)
- ⑤ PARCEL MAP (883 M 17)
- ⑥ SUNNYSIDE ADDITION (K M 46-47)
- ⑦ CALIFORNIA STATE HIGHWAY MONUMENT MAP
S.C.L. 2 PA, A., S-70.9 & S-70.10
- ⑧ GRANT DEED (DOC. 3933680)
- ⑨ RECORD OF SURVEY (963 M 35)
- ⑩ GRANT DEED (DOC. 23040335)
- ⑪ GRANT DEED (DOC. 8577140)
- ⑫ GRANT DEED (DOC. 23593463)
- ⑬ GRANT DEED (DOC. 24637368)

1. ALL DISTANCES SHOWN HEREON ARE IN FEET AND DECIMALS THEREOF
2. THIS RECORD OF SURVEY IS BEING FILED IN COMPLIANCE WITH SECTION 8762, PARAGRAPHS (b)(1), (2), (3) AND (4) OF THE PROFESSIONAL LAND SURVEYORS ACT.

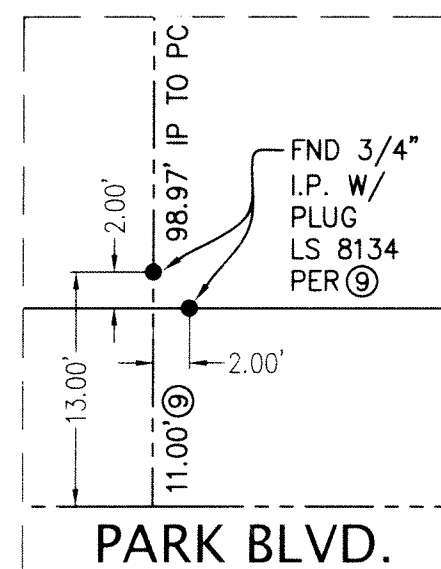

DETAIL "A"
NOT TO SCALE



0 20 40 80 120

Scale 1" = 40'

LANDS OF
SI 45, LLC
(DOC. 23593463)

RECORD OF SURVEY

LANDS OF 3290 PARK BOULEVARD, LLC, BEING ALL OF LOTS 5, 6, 7 AND A
PORTION OF THAT CERTAIN PARCEL DENOTED AS LOT 8 OF BLOCK 9 OF THAT
CERTAIN MAP ENTITLED, "MAP NO. 2 -SUNNYSIDE ADDITION TO THE TOWN OF
MAYFIELD" FILED ON DECEMBER 19, 1905 IN BOOK L, AT PAGE 12,
SANTA CLARA COUNTY RECORDS,
AND LYING WITHIN THE

CITY OF PALO ALTO – SANTA CLARA COUNTY
STATE OF CALIFORNIA
SEPTEMBER, 2024



350 Scott Boulevard, Building 22
Santa Clara, California 95054

Phone: (408) 727-6665
www.kierwright.com

THIS MAP CORRECTLY REPRESENTS A SURVEY MADE BY ME OR UNDER MY DIRECTION
IN CONFORMANCE WITH THE REQUIREMENTS OF THE PROFESSIONAL LAND SURVEYORS'
ACT AT THE REQUEST OF NEWMARK, INC., IN APRIL, 2023.

DATED THIS 13th DAY OF September, 2024.

 RYAN M. AMAYA
 P.L.S. NO. 8134

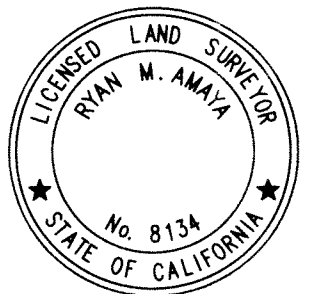

THIS MAP HAS BEEN EXAMINED IN ACCORDANCE WITH SECTION 8766 OF THE
PROFESSIONAL LAND SURVEYORS' ACT THIS 24 DAY OF SEPTEMBER, 2024.

AUGUST HANKS, COUNTY SURVEYOR
PLS NO. 9274

JEREMY KOENIG, DEPUTY COUNTY SURVEYOR
PLS NO. 9394



FILED THIS 26th DAY OF September
2024, AT 2:23 P.M. IN BOOK 965 OF MAPS, AT PAGE 29
AT THE REQUEST OF KIEP & WRIGHT.

FILE NO. 25704592 FEE: \$ 85.00

REGINA ALCOMENDRAS, COUNTY RECORDER

BY: Edith Pacheco
DEPUTY Edith Pacheco

APN: 132-38-057

GRID SHEET: 16-11-81

JOB: NO. A23375

SHEET 1 OF 1 SHEETS

25704592

Book
965
Page
29